

RETRACTA (Series 2)

INSTRUCTION MANUAL FOR ALL MODELS EXCEPT OXY-ACETYLENE and OXY-LPG

Thank you for purchasing a Macnaught Auto Rewind Hose Reel.

The Macnaught range of hose reels are a breakthrough in industrial quality hose reel design, performance, durability, versatility and cost. The efficiency, safety and convenience benefits of auto rewind hose reels are now available for most situations where a hose is required.

Manufactured from the highest quality weather resistant materials, the tough high – impact polypropylene is U.V. stabilised, designed for all purpose corrosion-free durability. The rewind mechanism is lubricated and sealed for trouble-free operation.

This retractable hose reel promotes a neat and tidy good looking work area, reducing the possibility of accidents, and improves the work environment. Safety is enhanced by low recoil tension even with the hose fully extended.

With your appropriate care, combined with the Macnaught guarantee of dependable after sales service, you will be assured of continuous safe, efficient and reliable product operation.

GENERAL INFORMATION

This manual assists you in operating and maintaining your new Retractable hose reel. The information contained will help you ensure many years of dependable performance and trouble free operation.

Please take a few moments to read through this manual before installing and operating your Retractable reel. If you experience problems with the product, refer to the procedures contained within this instruction manual. If you require further assistance please contact your local Macnaught distributor, or local Macnaught service centre.

IMPORTANT INFORMATION

PLEASE READ THIS SAFETY INFORMATION CAREFULLY BEFORE USE.

Please read and retain this instruction manual to assist you in the operation and maintenance of this quality product.

Your safety is important to us. Please read, understand and follow all safety instructions listed below. Some of these instructions alert you to the potential for personal injury. “Cautions” listed throughout the manual advise of potential practices or procedures which may cause damage to your equipment.

Make sure all operators have access to adequate instructions about safe operating and maintenance procedures.

This hose reel contains a pre-tensioned spring inside the drum assembly. For safety reasons the drum assembly is a non-repairable item. DO NOT under any circumstances try to open the drum assembly. A new drum assembly will be required if the spring is damaged.



DO NOT exceed the maximum working pressure stated on the product label.

The maximum installation height is 4.5 meters (15ft) above the ground.

The maximum weight of hose end tools is 2kg (4lb).

This reel contains a positive latching mechanism, which enables the reel to be mounted in any position

INSTALLATION

- Attach the carry handle to the reel casing above the reel/hose mouth, using the screws provided.
- The reel can only be mounted in any position. The most common mounting positions are shown below. (Refer Fig 1,2,3,4)

If you choose the most popular positions (1) and (2) you should use the standard (BU100) bracket. If using positions (3) and (4) you will need the optional bracket (BB100).

Fig.1 Wall / BU100



Up to 6ft above ground

Fig.3 Floor / Bench / BB100



Fig.2 Overhead / BU100



Up to 15ft above ground

Fig.4 High Wall / BB100



Between 6ft and 15ft above ground

- c) Fix mounting bracket in required location and position reel onto bracket. Brackets can be padlocked for additional security.
- d) Connect supply hose to reel inlet allowing sufficient space for reel to swivel 180° on bracket. Swivel rotation can be avoided (in the overhead position only) by adding the locking bracket (RB9) supplied.

POSITIVE LATCH OPERATION

Pull out the hose to the required length.

Note: A clicking noise can be heard every half revolution of the drum.

To latch the reel, allow the reel to slowly retract after hearing the 1st, 2nd or 3rd click.

To unlatch the reel, slowly pull out the hose until the clicking noise stops, then let the hose slowly retract until the hose stopper rests against the reel mouth.



CAUTION

To prevent injury or damage occurring, do not let go of the hose during rewinding.

MAINTENANCE

This section details the step-by-step procedures that you may require for the general use and maintenance of your reel. Please keep this instruction manual for future reference.

REMOVAL/ REPLACEMENT OF INLET CONNECTION SIDE PLATE

- a) Pull the hose out until it is fully extended and allow the hose to latch after hearing the 1st, 2nd or 3rd click.
- b) Place reel on a clean bench with the inlet side plate (1) face up. Remove screw located at the edge of the inlet plate. Rotate plate clockwise.
- c) Swivel assembly and hose will come away attached to the inlet side plate.
- d) To replace inlet side plate, suspend reel between your body and edge of bench. Reposition plate and turn counter-clockwise and re-locate the side screw.

SPRING TENSION AND LATCH SIDE PLATE REMOVAL

- a) Place reel on a clean bench with latching plate (9) face up.
- b) Release spring tension by opening tension plate (8) and place handle of a pair of pliers in the exposed slots. Grip the pliers firmly and remove the two screws holding the tension plate (8) and carefully allow the tension plate to slowly unwind counter-clockwise.
- c) Remove screw holding tension plate and remove tension plate. Remove screw located at the edge of the latching plate. Turn latching plate clockwise and remove, this will expose the latching cup assembly.
- d) To replace latching plate, suspend reel between your body and edge of the bench. Reposition the plate and turn counter-clockwise. Relocate side screws, replace tension plate and fixing screw.

- e) Reload spring tension by using the same tool (as in step B) and wind tension plate clockwise until hose stopper is firmly against the reel mouth, some resistance will be felt. Then, add approximately six (6) complete 360° tension turns. Hold the tension plate in this position, align dimples on tension plate latching side plate and replace the two screws. Close tension plate and cover.

SWIVEL SEAL REPLACEMENT

- a) Place reel on a clean bench with inlet side plate (1) face up.
- b) Remove the inlet side plate (Refer Removal/Replacement Inlet Connection Side Plate).
- c) Remove circlip (4) from end of swivel shaft assembly (2) and slide the inlet shaft from the swivel body (3).
- d) Carefully remove the existing O-Rings by lifting O-Rings out from grooves using a small screwdriver. With O-Rings extended, cut through the O-Ring onto the screwdriver face. Be careful you do not score O-Ring grooves.



CAUTION:

Do not damage or score inlet shaft surface when removing or cutting O-Ring.

- e) Before fitting new O-Rings ensure that both inlet shaft and swivel are thoroughly wiped clean.

SWIVEL RE-ASSEMBLY:

- a) Slide inlet shaft back into the swivel body and replace circlip.
- b) Slide inlet shaft back into the drum assembly (5), pushing complete unit home.
- c) Replace inlet side plate. (Refer to “Removal/Replacement Inlet Connection Side Plate”)

HOSE REPLACEMENT

- a) Pull the hose out until it is fully extended and allow the hose to latch after hearing the 1st, 2nd or 3rd click.
- b) Remove the inlet side plate (1) (Refer “Removal / Replacement of Inlet Connection Side Plate”). The swivel shaft assembly (2) will come away attached to the inlet side plate.
- c) Remove hose from swivel body (3). Remove remaining old hose from the mouth of the reel.
- d) Use only recommended length and type of replacement hose.
- e) Feed the new hose through top of reel mouth and into opening on reel drum which gives access to the swivel compartment. Replace and secure the internal hose stopper 5” from the end of hose assembly. Reconnect hose.
- f) Replace inlet side plate (1) (Refer “Removal/Replacement Inlet Connection Side Plate”).
- g) Place the reel in a vertical position and while holding the reel pull the hose out and switch to free run mode. The hose will now rewind. Carefully guide the hose onto the drum.
- h) If the replacement hose is the same length as the old hose no tension adjustment is necessary. If tension adjustment is required follow the ‘Spring Tension’ procedure (Refer to “Spring Tensioning and Latch Side Plate Removal”).



CAUTION:

Test reel for leaks prior to any further use.

PARTS DIAGRAM

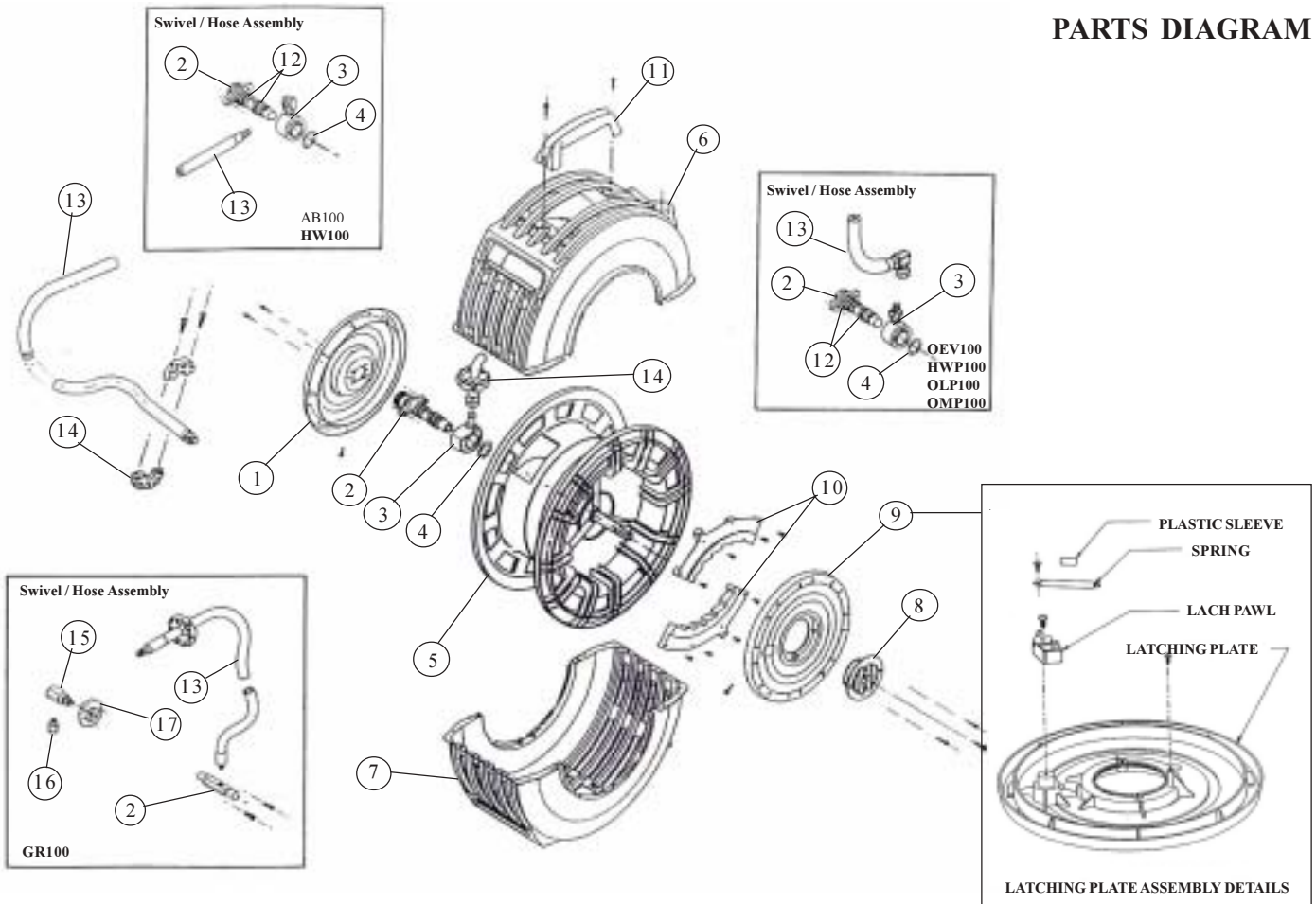

SPARE PARTS LIST

ITEM	DESCRIPTION	PART / SET	AB 100	AR 100	AR 200	AW 100	AW 200	CW 100	DR 100	GR 100
1	INLET SIDE PLATE		order RP34s	order RP34s	order RP34s	order RP34s	order RP34s	order RP34s	order RP34s	order RP34s
2	SWIVEL SHAFT	Seals incl'd	RS100s (BSP)	RS27s (NPT)	RS48s (NPT)	RS27s (NPT)	RS48s (NPT)	RS48s (NPT)	RS48s (NPT)	RS44s (NPT)
3	SWIVEL BODY		RS26s (BSP)	RS46s (BSP)	RS26s (BSP)	RS46s (BSP)	RS46s (BSP)	RS46s (BSP)	RS46s (BSP)	RS43s (BSP)
4	CIRCLIP									
5	DRUM ASSEMBLY		RP35-Black	RP43-Black	RP35-Black	RP33-Black	RP35-Black	RP35-Black	RP33-Black	RP35-Black
6	OUTER CASE ASSEMBLY		RP36Cs*	RP36Cs*	RP36Cs*	RP36Cs*	RP36Cs*	RP36Cs*	RP36Cs*	RP36Cs*
7	OUTER CASE-PLAN									
8	TENSION PLATE ASSEMBLY									
9	LATCHING PLATE ASSEMBLY		RP34s	RP34s	RP34s	RP34s	RP34s	RP34s	RP34s	RP34s
10	LATCHING PLATE									
11	CARRY HANDLE		order RP36Cs*	order RP36Cs*	order RP36Cs*	order RP36Cs*	order RP36Cs*	order RP36Cs*	order RP36Cs*	order RP36Cs*
12	SEAL SET		BS115-1K	BS115-1K	BS115-1K	BS115-1K	BS115-1K	BS115-1K	BS115-1K	
13	HOSE KIT ASSEMBLY		RH101s	RH35s	RH22s	RH66s	RH77s	RH40s	RH3s	RH45s
14	HOSE STOPPER									
15	INLET SWIVEL ASSEMBLY		N/A	N/A	N/A	N/A	N/A	N/A	N/A	SB6s
16	INLET ADAPTOR		N/A	N/A	N/A	N/A	N/A	N/A	N/A	RS40s
17	BEARING SET incl SCREWS		N/A	N/A	N/A	N/A	N/A	N/A	N/A	RS36s
18	NOZZLE SET		N/A	N/A	N/A	N/A	N/A	RH51s	RH11s	N/A
	LOCKING BRACKET		RB9s	RB9s	RB9s	RB9s	RB9s	RB9s	RB9s	RB9s
	STANDARD WALL BRACKET		BU100	BU100	BU100	BU100	BU100	BU100	BU100	BU100
	FEEDER HOSE ASSEMBLY		N/A	N/A	N/A	N/A	N/A	N/A	RH22s	N/A

ITEM	DESCRIPTION	PART / SET	FR 300	HW 100	HWP 100	OLP 100	OMP 100	PW 100	WP 100	OEV 100
1	INLET SIDE PLATE		order RP34s	order RP34s	order RP34s	order RP34s	order RP34s	order RP34s	order RP34s	order RP34s
2	SWIVEL SHAFT	Seals incl'd	RS105s (BSP)	RS52s (NPT)	RS90s (NPT)	RS51s (NPT)	RS51s (NPT)	RS46s (NPT)	RS68s (NPT)	RS51s (NPT)
3	SWIVEL BODY		RS64s (BSP)	RS85s (BSP)	RS50s (BSP)	RS50s (BSP)	RS48s (BSP)	RS67s (BSP)	RS50s (BSP)	
4	CIRCLIP									
5	DRUM ASSEMBLY		RP35-Black	RP35-Black	RP35-Black	RP35-Black	RP35-Black	RP35-Black	RP33-Black	RP35-Black
6	OUTER CASE ASSEMBLY		RP36Cs*	RP36Cs*	RP36Cs*	RP36Cs*	RP36Cs*	RP36Cs*	RP36Cs*	RP36Cs*
7	OUTER CASE-PLAN									
8	TENSION PLATE ASSEMBLY									
9	LATCHING PLATE ASSEMBLY		RP34s	RP34s	RP34s	RP34s	RP34s	RP34s	RP34s	RP34s
10	RATCHET PLATE									
11	CARRY HANDLE		order RP36Cs*	order RP36Cs*	order RP36Cs*	order RP36Cs*	order RP36Cs*	order RP36Cs*	order RP36Cs*	order RP36Cs*
12	SEAL SET		BS115Es	BS115Es	order RS85s (BSP) or RS90s (BSP)	BS115-1K	BS115-1K	BS115-1K	BS115Vs	BS115-1K
13	HOSE KIT ASSEMBLY		RH78s	RH41s	RH44s	RH1s	RH44s	RH100s	RH50s	RH88s
14	HOSE STOPPER									
15	INLET SWIVEL ASSEMBLY		N/A	N/A	N/A	N/A	N/A	N/A	N/A	N/A
16	INLET ADAPTOR		N/A	N/A	N/A	N/A	N/A	N/A	N/A	N/A
17	BEARING SET incl SCREWS		N/A	N/A	N/A	N/A	N/A	N/A	N/A	N/A
18	NOZZLE SET		N/A	N/A	N/A	N/A	N/A	N/A	N/A	N/A
	LOCKING BRACKET		RB9s	RB9s	RB9s	RB9s	RB9s	RB9s	RB9s	RB9s
	STANDARD WALL BRACKET		BU100	BU100	BU100	BU100	BU100	BU100	BU100	BU100
	FEEDER HOSE ASSEMBLY									

* Nominate color when ordering

TROUBLE SHOOTING GUIDE

PROBLEM	REMEDY
<p>1. Hose will not retract</p> <ol style="list-style-type: none"> Hose bunching. Spring tension too light. Replacement hose too heavy. 	<ol style="list-style-type: none"> Pull hose out and rewind guiding the hose to avoid bunching. Refer to “Spring tension and latch side plate removal”. Replace hose with recommended hose, refer to “Hose Replacement”.
<p>2. Reel will not latch</p> <ol style="list-style-type: none"> The hose has been pulled past the latching teeth. Broken latching pawl or pawl spring. 	<ol style="list-style-type: none"> Allow the reel to slowly retract after hearing the 1st, 2nd or 3rd click.1. Replace broken components. Refer to “Spring Tension and Latch Side Plate Removal”.
<p>3. Reel Leaks.</p> <ol style="list-style-type: none"> Damaged Hose. Loose fittings. Worn swivel seals 	<ol style="list-style-type: none"> Replace hose. Refer to “Hose Replacement”. Tighten Fitting. refer to “Removal / Replacement of inlet Connection Side Plate”. Refer to “Swivel Seal Replacement”.

WARRANTY POLICY

Macnaught Limited (“Macnaught”) warrants that Products purchased after 1st of July 1999 will be free from any defects caused by faulty materials or workmanship for a period of (5) years from the date of purchase of the product.

For componentry contained in the product which are subject to wear, the warranty period will be (12) months from the date of purchase of the product.

Provided that during the Warranty period:

- Macnaught receives notice setting out full details of any defect in any product and details of the time and place of purchase.
- The Purchaser, at their own cost returns the product to the nearest authorized Macnaught service center.

Macnaught shall, at its option repair or replace any product found defective by its inspection.

This warranty does not cover failure of parts or components due to normal wear or damage, which in the judgment of Macnaught, arises from misuse, abrasion corrosion, negligence, accident, substitution of non-Macnaught parts, faulty installation or tampering.

If Macnaught inspection discloses no defect in material or workmanship, repair or replacement and return will be made at customary charges.

Macnaught’s liability and the purchaser’s rights under this Warranty shall be limited to such repair or replacement and in particular, shall not extend to any direct, special, indirect or consequential damage or losses of any nature.

The foregoing warranty supersedes, voids and is in lieu of all or any other warranties.

Note:

This warranty does not form part of, nor does it constitute, a contract between Macnaught and the purchaser. It is additional to any warranty given by the seller of the products and does not exclude, limit, restrict or modify the rights and remedies conferred upon the purchaser, or the liabilities imposed on the seller, by any statute or other laws in respect of the sale of the product.



Macnaught Pty Ltd
 PO Box 90 Arncliffe NSW 2205 Australia
 Telephone (02) 9567 0401
 Facsimile (02) 9597 7773